

# BROOKLYN POINT

## RESIDENCES 15E-26E

2 BEDROOMS  
2 BATHROOMS  
1,169 SQFT  
108.6 SQM

- Gracious entry foyer
- Corner living room
- Expansive eat-in kitchen
- Master bedroom suite with dual closets
- Master bathroom with radiant heat flooring
- Split bedroom layout
- Dual exposures
- Custom Waterworks fittings
- Premium Miele appliance package
- Imported stone and custom finishes
- 5" wide flat-cut stained oak flooring

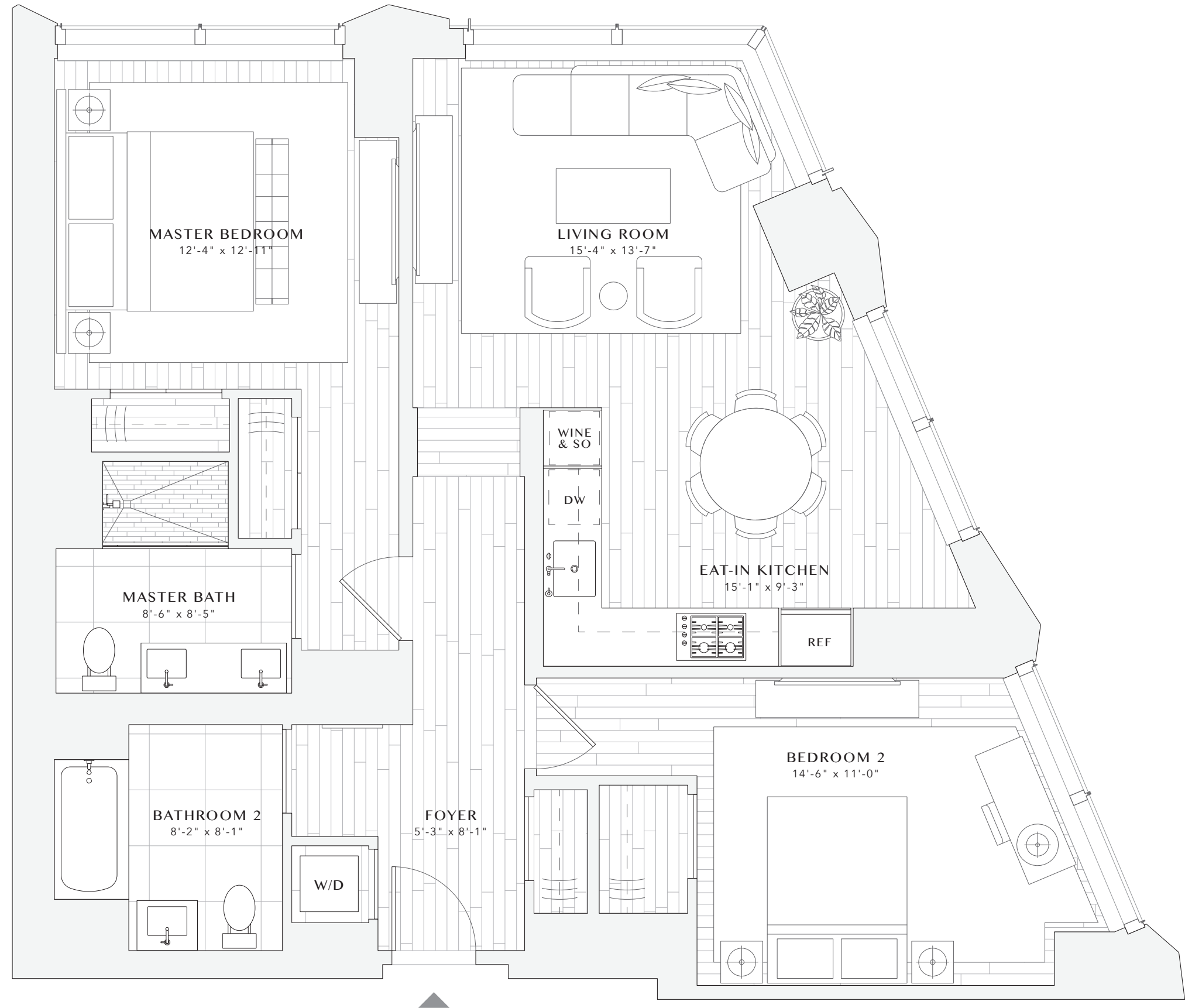
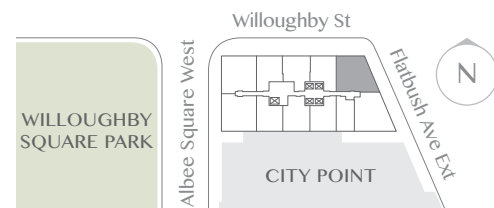

SALES & DESIGN GALLERY  
384 BRIDGE STREET, BROOKLYN, NY 11201

[info@BrooklynPointNYC.com](mailto:info@BrooklynPointNYC.com)  
[BrooklynPointNYC.com](http://BrooklynPointNYC.com)  
718.222.5770

The complete offering terms are in an offering plan available from Sponsor. File No. C16-0008. Sponsor: 138 Willoughby LLC, 805 Third Avenue, Seventh Floor, New York, NY 10022. All dimensions are approximate and subject to normal construction variances and tolerances. Square footage exceeds the usable floor area. Sponsor reserves the right to make changes in accordance with the terms of the Offering Plan. Plans and dimensions may contain minor variations from floor to floor. Refer to the window patterns for this unit depicted on the floor plans included as Exhibit 3 in Part 2 of the Offering Plan. Units will not be offered furnished. Furniture layouts shown are for concept only and are not coordinated with building systems. No representation or warranty is made that a Unit Owner will be able to implement the furniture layout shown above. Equal Housing Opportunity.